

TMC-212 Series

Residential Controllers

Proven modularity and customer-driven features offer residential applications the utmost in:

Versatility

- Station count modularity from four to 12 stations, in two-station modules that are backward and forward compatible with the GreenKeeper 212 controller, adapts to the needs of changing landscapes
- Two levels of lightning protection meet a wide range of regional weather conditions

Convenience

- Features, such as non-volatile memory and short detection, that can dramatically reduce call-backs and shorten maintenance time
- Easy-to-read display and user-friendly interface ensure fast, accurate programming

Value

- Better value at higher station counts than competitive models
- Sophisticated styling and high-impact plastic case for professional-grade appearance and performance

Introducing TMC-212—

the feature-packed modular controller designed to meet the needs of contractors



Modular **TMC-212**

TORO

Count on it.

TMC-212 Series

Residential Controllers

Modularity

- Station-count modularity for flexibility and reduced inventory requirements (two to 12-stations—base model is four stations)
- Station modules are backward and forward compatible with Toro's GreenKeeper 212 modular controller

Programmability

- Three independent programs and four start times per program provide exceptional scheduling flexibility
- Three scheduling choices include:
 - Seven-day calendar
 - Odd/even days with day exclusion
 - One- to seven-day interval with day exclusion
- Compatible with normally open and normally closed rain sensors, including bypass switch
- Well recovery/station delay from one to 60 seconds and one to 60 minutes
- Pump start delay from one to 60 seconds
- Master valve on/off by program for flexibility
- Clear memory feature erases programming by program
- Program stacking prevents dropped programs when start times overlap

Professional-grade

- Indoor and key-lock outdoor models offer installation flexibility and improved security against vandalism
- Non-volatile memory requires no batteries and holds programming for up to five years, reducing call-backs
- Short detection for faster troubleshooting
- Compatible with Toro's EZ Remote for periodic maintenance

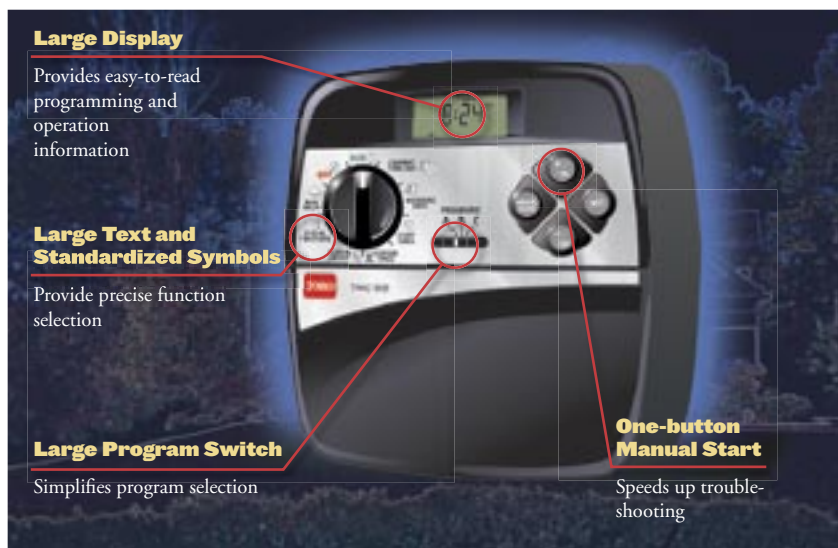

Electrical Specifications

- Input Power
 - 120 VAC (60 Hz) transformer
 - 18VA maximum (indoor models); 20 VA maximum (outdoor models)
 - UL/CSA-listed transformer
- Station Output Power:
 - 24 VAC (50/60 Hz)
 - 0.30 amps per station maximum
 - 0.30 amps pump/master valve
 - 0.60 amps total load
- Heavy-duty electrical surge protection for both input power and field outputs



Two-station modules (available in standard and high-surge) provide great flexibility

Mechanical Specifications

Indoor Model

- Dimensions:
 - 8" W x 8" H x 2 1/4" D (203 x 203 x 57mm)
- Shipping weight (including carton):
 - 3 lbs. 4 oz. (1,5 kg)

Outdoor Model

- Dimensions:
 - 12" W x 9" H x 3 1/4" D (305 x 229 x 83mm)
- Shipping weight (including carton):
 - 5 lbs. 6 oz. (2,5 kg)

TMC-212 vs. GreenKeeper: Key Product Enhancements

- Well recovery**
- Pump start delay**
- Clear by program**
- Day exclusion in odd/even or day-interval active days**
- Program stacking**
- Programmable master valve**
- Non-volatile memory**
- Short detection**
- Compatibility with all rain sensors**

Specifying Information

Model	Description
TMC-212-ID	Toro Modular Controller, 2-12 stations, 4-station Indoor Model
TMC-212-OD	Toro Modular Controller, 2-12 stations, 4-station Outdoor Model
TMC-212-ODH	Toro Modular Controller, 2-12 stations, 4-station Outdoor Module, High Surge
TSM-O2	Toro Station Modules – 2-station Module
TSM-O2-H	Toro Station Modules – 2-station Module, High Surge

Example: A 4-station TMC-212 Controller in an outdoor cabinet would be specified as: TMC-212-OD



The Toro Company • Irrigation Division • An ISO 9000-Certified Company

• PO Box 489 • Riverside, CA • 92502 • (800) 664-4740 • www.toro.com

©2005 The Toro Company • All Rights Reserved • June 2005